



6208 NR Deep groove ball bearings

- SKF Explorer

Deep groove ball bearings

Bearing data

[Tolerances](#),

Normal (metric), P6, P5, Normal (inch),

[Radial internal clearance](#),

Matched bearing pairs, Stainless steel
d < 10 mm, Other bearings

Bearing interfaces

[Seat tolerances for standard conditions](#),

[Tolerances and resultant fits](#)

Technical specification

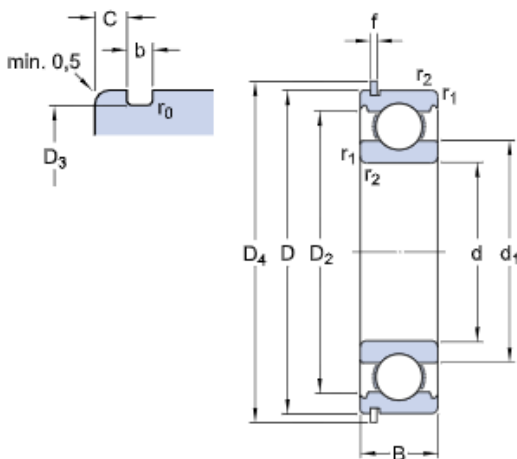

DIMENSIONS

d	40 mm	Bore diameter
D	80 mm	Outside diameter
B	18 mm	Width
d ₁	≈ 52.6 mm	Shoulder diameter
D ₂	≈ 69.8 mm	Recess diameter
D ₃	76.81 mm	Diameter of snap ring groove
D ₄	86.6 mm	Outside diameter of snap ring
b	1.9 mm	Width of snap ring groove
C	3.28 mm	Distance outer ring from side face to snap ring groove
f	1.7 mm	Width of snap ring
r ₀	max. 0.6 mm	Bottom radius of snap ring groove
r _{1,2}	min. 1.1 mm	Chamfer dimension

ABUTMENT DIMENSIONS

d _a	min. 47 mm	Diameter of shaft abutment
D _a	max. 73 mm	Diameter of housing abutment
D _b	min. 88 mm	Diameter of snap ring recess in the housing

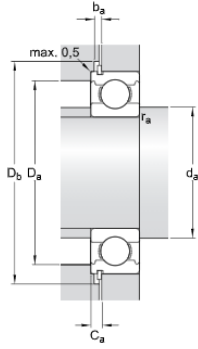

b_a	min. 2.2 mm	Width of snap ring recess in the housing
C_a	max. 4.98 mm	Distance from outer ring side face to snap ring back face
r_a	max. 1 mm	Radius of shaft or housing fillet

CALCULATION DATA

C	32.5 kN	Basic dynamic load rating
C_0	19 kN	Basic static load rating
P_u	0.8 kN	Fatigue load limit
	18 000 r/min	Reference speed
	11 000 r/min	Limiting speed
k_r	0.025	Minimum load factor
f_0	14	Calculation factor

MASS

	0.38 kg	Mass bearing
--	---------	--------------

INCLUDED PRODUCTS

SP 80	Snap ring
-------	-----------

TOLERANCE CLASS

P6	Dimensional tolerances
P6	Radial run-out